

THE COPYRIGHT OF THIS DRAWING IS VESTED WITH CW O'BRIEN ARCHITECTS LIMITED AND MUST NOT BE COPIED OR REPRODUCED WITHOUT THE CONSENT OF THE COMPANY.

FIGURED DIMENSIONS ONLY TO BE TAKEN FROM THIS DRAWING. DO NOT SCALE.

ALL CONTRACTORS MUST VISIT THE SITE AND BE RESPONSIBLE FOR CHECKING ALL SETTING OUT DIMENSIONS AND NOTIFYING THE ARCHITECT OF ANY DISCREPANCIES PRIOR TO ANY MANUFACTURE OR CONSTRUCTION WORK.

NOTES:

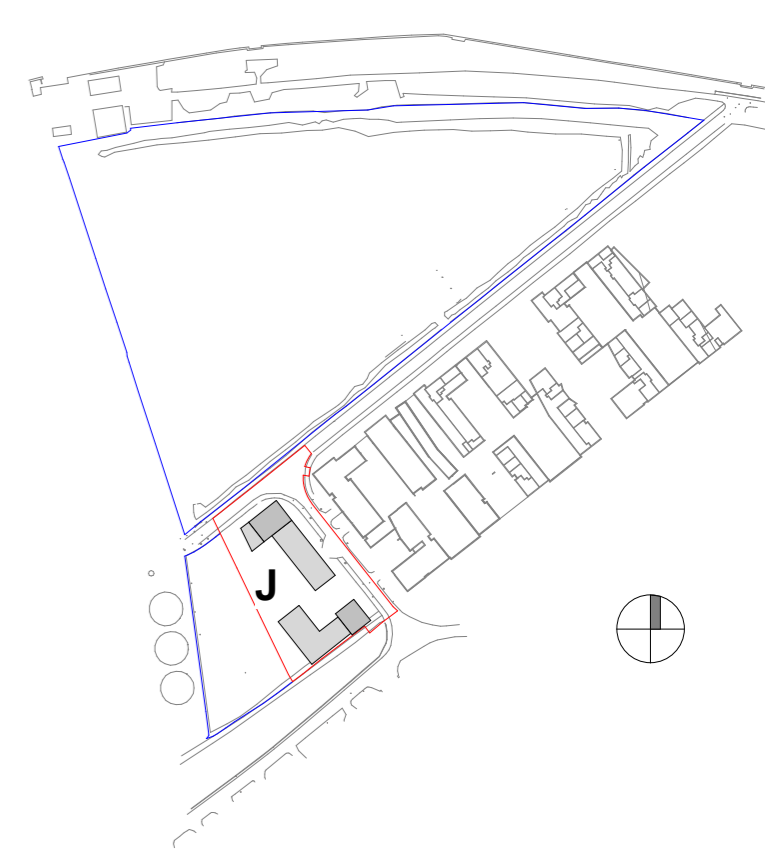

Accommodation Schedule-BLOCK J_L109		
Name	Area Type	Area
J-0901	1 BED	53 m ²
J-0902	2 BED	77 m ²
J-0903	2 BED	77 m ²
J-0904	1 BED	50 m ²
J-0905	2 BED	68 m ²
J-0906	3 BED	104 m ²
J-0907	2 BED	73 m ²

REFER TO LANDSCAPE AND ENGINEERING DRAWINGS FOR FURTHER INFORMATION

— SITE OUTLINE RED
— LANDS IN APPLICANT'S OWNERSHIP

FLOOR PLAN KEY:
 EH - ENTRANCE HALL
 ST - STORAGE
 HP - HOT PRESS
 KIT/LIV/DIN - KITCHEN + LIVING + DINING ROOM

AREA TYPES

- 1 BED
- 2 BED
- 2 BED-DUPLEX
- 3 BED
- CIRCULATION

Rev	Date	Description	Issued By
P09	21/03/2022	ISSUED FOR PLANNING	EB
P08	17/12/2021	ISSUED FOR REVIEW	EB
P07	02/12/2021	ISSUED FOR REVIEW	EB
P06	12/11/2021	ISSUED FOR REVIEW	EB
P05	10/09/2021	ISSUED FOR PRE-PLANNING	EB
P04	01/09/2021	ISSUED FOR REVIEW	EB
P03	05/07/2021	FIRST ISSUE	EB
P02	05/07/2021	LAYOUT REVISION	EB
P01	02/07/2021	FIRST ISSUE	EB

Project Stage
PLANNING

Client:
 Tiznow Property Company Limited
 (Comer Group Ireland)

Project:
 RESIDENTIAL DEVELOPMENT
 The Former Cork Warehouse Company Site,
 Cork South Docks, Cork City

Drawing Title:
 PLAN - BLOCK J - LEVEL 09

Drawn	Checked	Paper Size	Scale	Date
VF	EB	A1	1 : 200 @A1	07/06/21

Project No.	Drawing No.	Classification	Revision
PE21055	2289		P09

File Name:
 PE21055-CWO-10-09-DR-A-2289

Status:
A1 - Authorized and accepted for planning stage



No.1 Sarsfield Quay, Dublin 7, D07 R9FH
 t: 01 518 0170 e: admin@cwoarchitects.ie
 Dublin | Cork | Galway | London | UK & Europe +
 www.cwoarchitects.ie

Please consider the environment before printing this sheet



1 PLAN - BLOCK J - LEVEL 09
 1 : 200