

THE COPYRIGHT OF THIS DRAWING IS VESTED WITH CW O'BRIEN ARCHITECTS LIMITED AND MUST NOT BE COPIED OR REPRODUCED WITHOUT THE CONSENT OF THE COMPANY.

FIGURED DIMENSIONS ONLY TO BE TAKEN FROM THIS DRAWING. DO NOT SCALE.

ALL CONTRACTORS MUST VISIT THE SITE AND BE RESPONSIBLE FOR CHECKING ALL SETTING OUT DIMENSIONS AND NOTIFYING THE ARCHITECT OF ANY DISCREPANCIES PRIOR TO ANY MANUFACTURE OR CONSTRUCTION WORK.

NOTES:

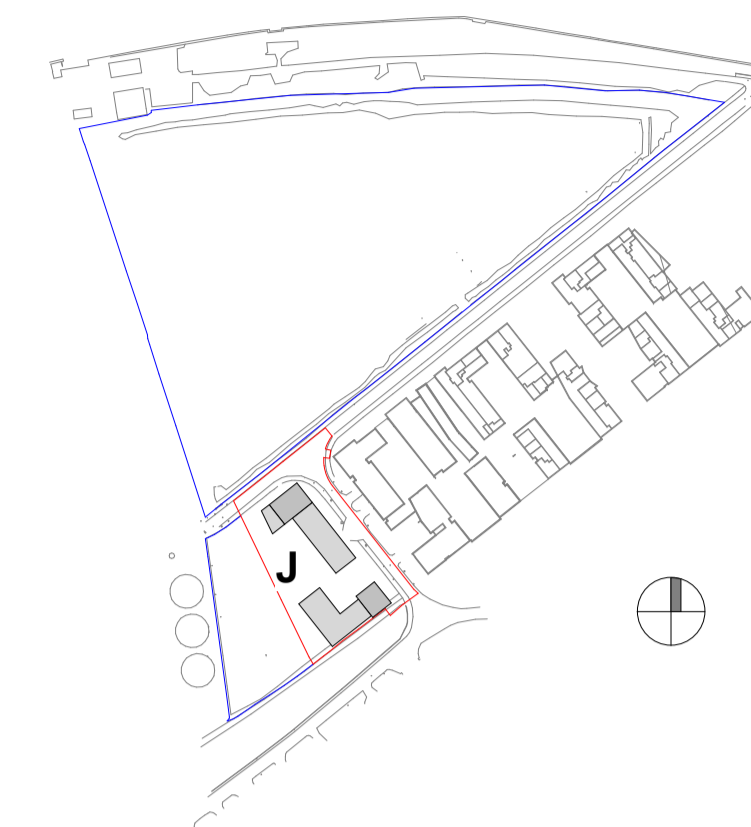

— SITE OUTLINE RED
— LANDS IN APPLICANT'S OWNERSHIP

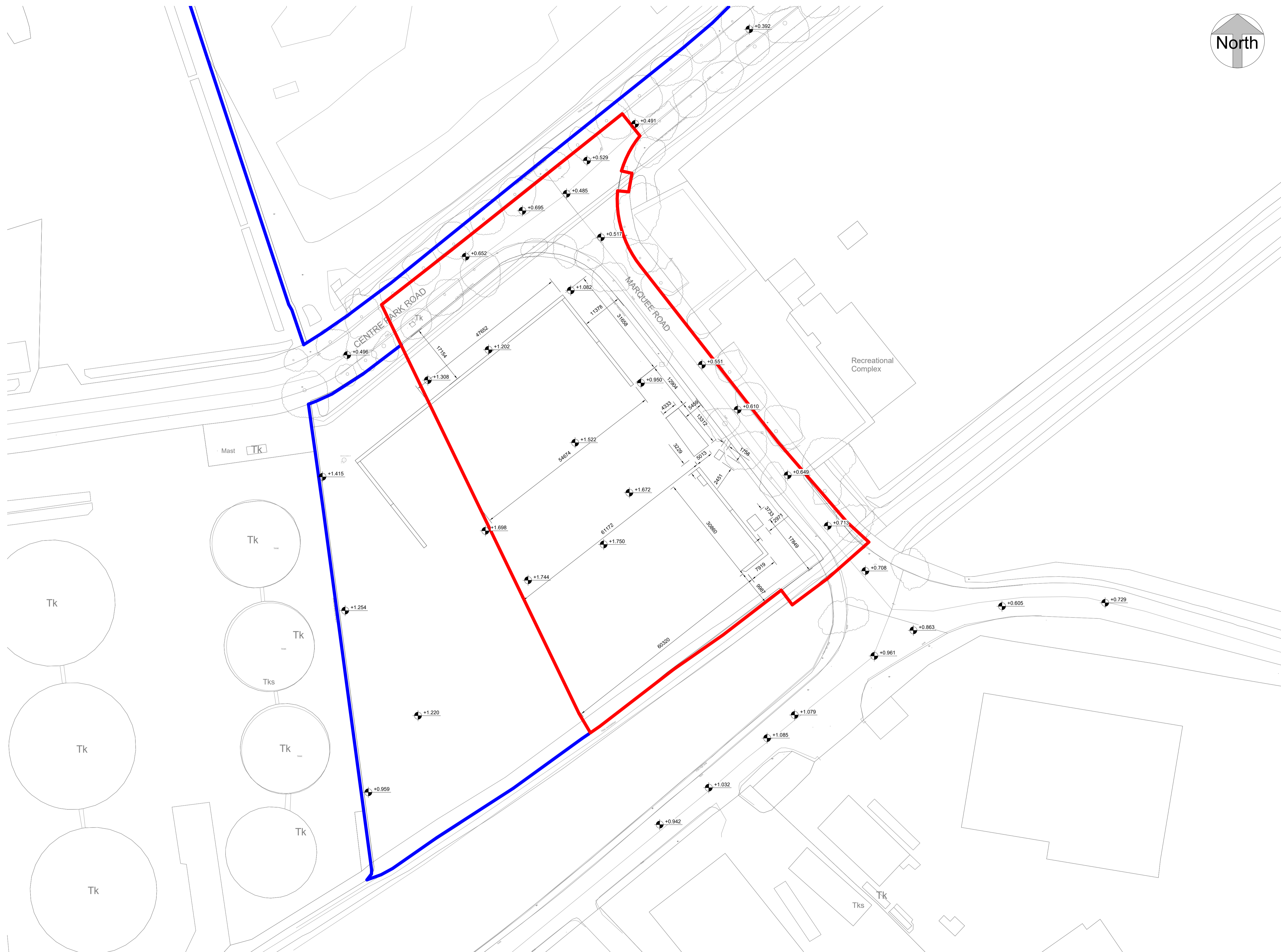

P05	21/03/2022	ISSUED FOR PLANNING	EB
P04	17/12/2021	ISSUED FOR REVIEW	EB
P03	02/12/2021	ISSUED FOR REVIEW	EB
P02	10/09/2021	ISSUED FOR PRE-PLANNING	EB
P01	01/09/2021	ISSUED FOR REVIEW	EB
Rev	Date	Description	Issued By

PLANNING

Client:
Tiznow Property Company Limited
(Comer Group Ireland)

Project:
RESIDENTIAL DEVELOPMENT
The Former Cork Warehouse Company Site,
Cork South Docks, Cork City

Drawing Title:
EXISTING SITE PLAN - BLOCK J

Drawn	Checked	Paper Size	Scale	Date
VF	EB	A1	1 : 500 @A1	09/01/21

Project No.	Drawing No.	Classification	Revision
PE21055	0105		P05

File Name:
PE21055-CWO-10-00-DR-A-0105

Status:
A1 - Authorized and accepted for planning stage



No.1 Sarsfield Quay, Dublin 7, D07 R9FH
t: 01 518 0170 e: admin@cwoarchitects.ie
Dublin | Cork | Galway | London | UK & Europe +
www.cwoarchitects.ie

Please consider the environment before printing this sheet